



Est. 1985

**FALCON®**

OPERATORS MANUAL / OPERATEURSHANDLEIDING

# Material Handling Implements / Materiaalhanteringsimplemente

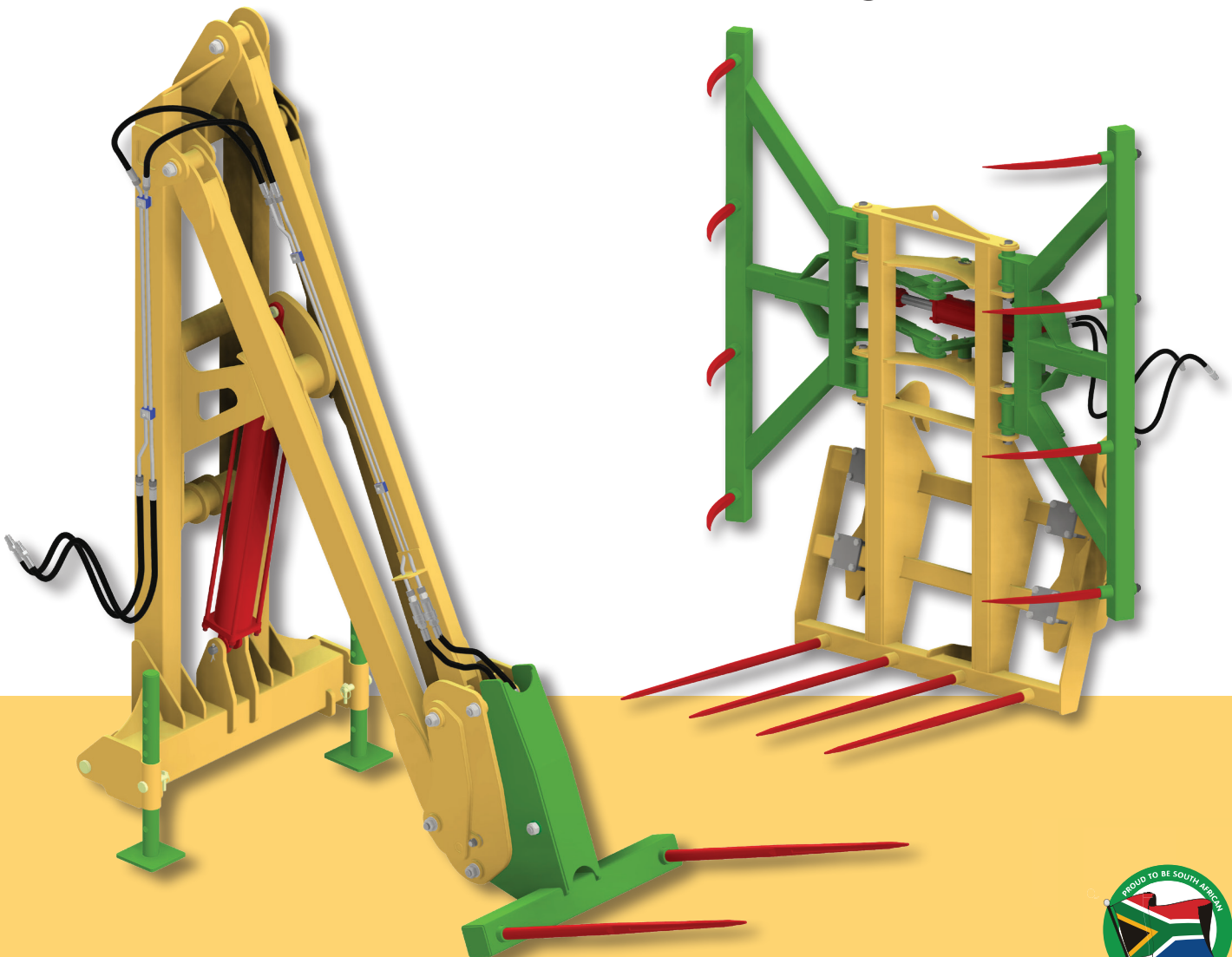

**CONTENTS**

FOREWORD	1
COMPANY PROFILE	2
WARRANTY AND DISCLAIMER	3
PRODUCT RANGE	5
INSTALLATION	7
OPERATION	9
MAINTENANCE	14
PARTS LISTS	17

**INHOUD**

VOORWOORD
MAATSKAPPYPROFIEL
WAARBORG EN VRYWARING
PRODUKREEKS
INSTALLERING
WERKING
INSTANDHOUDING
PARTELYSTE

Authorised Dealer / Gemagtigde handelaar:

Date of Sale / Verkoopsdatum:

Implement:

Model No. / Model Nr.:

Serial No. / Reeks Nr.:

Part number M8403  
Version 5  
Date of publication 2024/05/28

Onderdeelnummer  
Weergawe  
Datum van publisering

## FOREWORD



We at Falcon commend and congratulate you on the purchase of your Falcon implement, which we consider to be the best of its type available.

However, we would like to remind you that your success and satisfaction with the product will be greatly improved by you familiarising yourself with the contents of this manual. It contains important information relevant to the responsible operation, maintenance and most importantly, safe use of the product.

Note that failure to observe or comply with the provisions of this manual may result in unsafe operating conditions as well as damage to products and property which shall not be covered under warranty.

Should this manual become misplaced, damaged or destroyed, further copies are available from your Falcon dealer. Alternatively, this document is available for download from our website: [www.falconequipment.co.za](http://www.falconequipment.co.za)

### Symbols used in this document

	<b>Safety-critical notices</b>	Failure to comply with these notices may result in serious damage to equipment, personal injury or death.
	<b>Veiligheidskritieke kennisgewings</b>	Versuim om aan hierdie kennisgewings gehoor te gee kan ernstige skade aan toerusting, persoonlike beserings of dood tot gevolg hê.
	<b>Procedures and checks</b>	To be carried out by suitably competent persons in the course of installation, operation and maintenance of the equipment.
	<b>Prosedures en kontroles</b>	Moet deur toepaslik bekwame persone uitgevoer word by die installering, bedryf en instandhouding van die toerusting.
	<b>General information</b>	Information provided for references purposes, including any external references intended to be read in conjunction with this manual.
	<b>Algemene inligting</b>	Inligting vir verwysingsdoeleindes, insluitend enige eksterne verwysings wat bedoel is om saam met hierdie handleiding gelees te word.

## VOORWOORD

Ons by Falcon wens jou geluk met die aankoop van jou Falcon-implement, wat ons as die beste beskikbare werktuig in sy soort beskou.

Ons herinner u egter graag daaraan dat u sukses en tevredenheid met die produk grootliks verbeter sal word as u met die inhoud van hierdie handleiding vertrou raak. Dit bevat belangrike inligting met betrekking tot die verantwoordelike gebruik, instandhouding en, die heel belangrikste, veilige gebruik van die produk.

Let asseblief op dat versuim om die bepalings van hierdie handleiding na te kom tot onveilige bedryfstoeleende asook skade aan produkte en eiendom kan lei wat nie onder die waarborg gedek sal wees nie.

Indien hierdie handleiding dalk verloor, beskadig of vernietig sou word, is daar verdere kopieë by u Falcon-handelaar beskikbaar. Hierdie dokument kan ook van ons webwerf, [www.falconequipment.co.za](http://www.falconequipment.co.za), afgelaai word.

### Simbole wat in hierdie dokument gebruik word

## COMPANY PROFILE

Falcon Agricultural Equipment (Pty) Ltd is the largest manufacturer of rotary cutters in Africa. The company opened its doors in 1985, at its current premises in Howick, Kwazulu-Natal, South Africa. This is the ideal location as it is an agricultural area with a leading agricultural college nearby.

Our primary market is the agricultural sector, with niche efforts into the industrial and turf implement market. We distribute our products through a network of over 350 authorised dealers with approximately 110 dedicated mechanisation dealers countrywide. We also distribute our products across our borders into other African countries such as Botswana, Kenya, Malawi, Mozambique, Namibia, Uganda, Swaziland, Tanzania, Zambia, and Zimbabwe.

We manufacture the Falcon range of implements and our on-going programme of innovation and improvement ensures that we consistently launch implements to satisfy our customers' ever-changing needs.

The Falcon range includes slashers, Haymakers®, material handling implements, mulchers, mowers, spreaders, rotavators and flail implements. Each is designed to be simple, safe and serviceable, while offering excellent value for money. They are built to last and are capable of coping with the tough South African conditions.

In many parts of South Africa "Falcon" is the generic term for grass-cutting implements, making us the undisputed leader in our field. Delivery on a marketing promise is the foundation of any successful marketing drive and farmers buying the Falcon brand buy more than just a product - they buy the heritage and expertise of a company that has been around for a long time!

We also import a range of implements that complement the locally manufactured ones. These include the Amazone spreaders, sprayers, mowers and soil tillage implements (from Germany).

Falcon Agricultural Equipment (Pty) Ltd is committed to supporting our local communities in many different ways. Our main focus is the well-being of children and we provide a safe and suitable school environment for them, as well as school-related necessities.

Our team prides itself on its professional approach to business. We have built long-standing relationships with our dealers and their customers based on honesty, trust, respect and integrity. Excellent customer service is an important part of the Falcon promise.

## MAATSKAPPYPROFIEL

Falcon Agricultural Equipment (Edms.) Bpk. is die grootste vervaardiger van wentelsnyers in Afrika. Die maatskappy het sy deure in 1985 by sy huidige perseel in Howick, KwaZulu-Natal, Suid-Afrika, geopen. Die ligging is ideaal: in 'n boerderygebied met 'n vooraanstaande landboukollege naby.

Ons hoofmark is die landbousektor, met nisverkope in die nywerheids- en grasbaanimplement-markte. Ons versprei ons produkte deur 'n netwerk van meer as 350 gemagtigde handelaars met ongeveer 110 toegewyde meganisasiehandelaars landswyd. Ons versprei ook ons produkte oor ons grense na ander Afrikalande soos Botswana, Kenia, Malawi, Mosambiek, Namibië, Uganda, Swaziland, Tanzanië, Zambië, en Zimbabwe.

Ons vervaardig die Falcon-implementreeks en ons voortgesette program van vernuwing en verbetering verseker dat ons konstant implemente bekendstel wat ons kliënte se immer veranderende behoeftes bevredig.

Die Falcon-reeks sluit wentelsnyers, Hooimakers®, materiaalhanteringsimplemente, mulchers, grassnyers, strooiers, kapploë en vleëlimplemente in. Almal is ontwerp om eenvoudig, veilig en diensbaar te wees terwyl hulle uitstekende waarde vir geld bied. Hulle is gebou om te hou en ons strawwe Suid-Afrikaanse toestande die hoof te bied.

In baie dele van Suid-Afrika is "Falcon" die generiese term vir grassny-implemente, wat ons die onbetwiste leier op ons gebied maak. Die nakom van 'n bemarkingsbelofte is die grondslag van enige geslaagde bemarkingsveldtog, en boere wat die Falcon-handelsmerk koop, koop meer as net 'n produk – hulle koop die erfenis en deskundigheid van 'n maatskappy wat al lank in die land is!

Ons voer ook 'n reeks implemente in wat die plaaslik-vervaardigdes komplementeer. Dit sluit in die Amazone-strooiers, -spuite, -grassnyers en -grondbewerkings-implemente (uit Duitsland).

Falcon Agricultural Equipment (Edms.) Bpk. is verbonde tot die ondersteuning van ons plaaslike gemeenskappe op baie verskillende maniere. Ons hooffokus is die welsyn van kinders, en ons verskaf vir hulle 'n veilige en geskikte skoolomgewing, sowel as skoolverwante benodigdhede.

Ons span is trots op sy professionele benadering tot besigheid. Ons het langdurige verhoudings met ons handelaars en hul klante opgebou wat op eerlikheid, vertroue, respek en integriteit gebaseer is. Voortreflike klantediens is 'n belangrike deel van die Falcon-belofte.

## WARRANTY AND DISCLAIMER

Falcon products are manufactured in accordance with established quality standards and are accompanied by a limited warranty against defective materials and workmanship. In terms of this warranty, Falcon or an authorised Dealer may conduct reasonable repairs or replacement of products or parts of products, as required.

### General conditions of limited warranty

Any claim with respect to warranty shall satisfy the following minimum conditions.

- The implement has not been subjected to misuse, abuse, damage or acts of negligence.
- The Owner is in possession of, and can demonstrate an understanding and application of the provisions of this manual.
- The implement has been used exclusively for its intended purpose and in a configuration in which it was designed to operate.
- Installation, setup, operation and maintenance of the implement have been carried out in accordance with this manual.
- Maintenance of the implement has been carried out as prescribed in this manual, using original and approved parts.
- The implement has not been subjected to structural, mechanical or any other unauthorised modification or repair.
- A warranty claim has been reported to an authorised Dealer within the prescribed warranty period for the product concerned.

### Exclusions

The following items are excluded from warranty cover, including any costs relating to these.

- Parts reckoned as consumable or wearing parts.
- Products or parts of products exhibiting acceptable wear and tear.
- Temporary replacement, loan or hire of substitute parts or equipment.
- Transport and handling of affected products.
- Consequential damage or loss on the part of any person, organization or otherwise affected party.

### Validity

This warranty supersedes all previous conditions of warranty, whether expressed or implied, including any previous obligation or liability on the part of Falcon in respect of non-conforming or defective product.

### Disclaimer

Falcon maintains a programme of continuous product improvement and consequently reserves the right to change designs, specifications, descriptions and materials

## WAARBORG EN VRYWARING

Falcon-produkte word vervaardig ooreenkomstig met gevestigde gehalte-standaarde en word deur 'n beperkte waarborg teen defektiewe materiale en vakmanskap gedek. Kragtens hierdie waarborg mag Falcon of 'n gemagtigde Handelaar redelike herstelwerk of vervanging van produkte of produkonderdele uitvoer, soos vereis.

### Algemene voorwaardes van beperkte waarborg

Enige eis ten opsigte van die waarborg moet aan die volgende minimumvoorwaardes voldoen:

- Die implement is nie aan verkeerde gebruik, misbruik, beskadiging of verwaarlosing onderwerp nie.
- Die Eienaar is in besit van hierdie handleiding en kan 'n begrip en toepassing van die bepalings daarvan demonstreer.
- Die implement is uitsluitlik vir die bedoelde doel gebruik en in 'n konfigurasie waarin dit ontwerp is om bedryf te word.
- Installering, opstelling, bedryf en instandhouding van die implement het in ooreenstemming met hierdie handleiding plaasgevind.
- Instandhouding van die implement is uitgevoer soos in hierdie handleiding voorgeskryf, met gebruik van oorspronklike en goedgekeurde onderdele.
- Die implement is nie aan enige strukturele, meganiese of enige ander ongemagtigde wysiging of herstelwerk onderwerp nie.
- Kennis van 'n waarborg-eis is binne die voorgeskrewe waarborgtydperk vir die betrokke produk aan 'n gemagtigde Handelaar gegee.

### Uitsluitings

Die volgende items word van waarborgdekking uitgesluit, insluitend enige onkoste daaraan verbonde.

- Onderdele as verbruikbare of slytonderdele geag.
- Produkte of produkonderdele wat aanvaarbare slytasie vertoon.
- Tydelike vervanging, leen of huur van vervangingsonderdele of -toerusting.
- Vervoer en hantering van geaffekteerde produkte.
- Gevolglike skade of verlies aan of deur enige persoon, organisasie of andersins geaffekteerde party.

### Geldigheid

Hierdie waarborg vervang alle vorige waarborgvoorwaardes, hetsy eksplisiet of geïmpliseer, insluitend enige vorige verpligting of aanspreeklikheid van Falcon ten opsigte van nie-ooreenstemmende of defekte produkte.

### Vrywaring

Falcon handhaaf 'n program van voortdurende produkverbetering en gevolg behou ons die reg om ontwerpe, spesifikasies, beskrywings, materiale en enige ander

of construction and any other product attribute without prior notice. This includes no obligation to reflect such changes in documentation or literature or to provide any such changes to products previously sold or held in stock.

produkeienskap sonder voorafkennisgewing te wysig, insluitend geen verpligting om sulke veranderinge in dokumentasie of literatuur te weerspieël of aan te bring aan produkte wat voorheen verkoop of aangehou is nie.

#### Warranty Periods

Brands	Product groups	Components	Origin	Versions	Period
Falcon	Slashers Haymakers® Rollermowers Blowermowers™	Gearboxes	Imported	All	2y
			Falcon	F50	3y
			F80	3y	
		PTO shafts	Imported	All	1y
		OEM parts	Falcon	All	2y
	Dual-spindle Slashers Dual-spindle Haymakers® Flexwing Grassmulchers™ Fieldmulchers™ SD Mulchers Rotagang®	Gearboxes	Imported	All	1y
			Falcon	F50	2y
				F60	1y
			F80	2y	
		PTO shafts	Imported	All	1y
			OEM parts	Falcon	All
	Flail implements	Gearboxes	Imported	All	1y
		PTO shafts	Imported	All	1y
		OEM parts	Falcon	All	1y
	Rotavators	Gearboxes	Falcon	All	1y
		OEM parts	Falcon	All	1y
	Rotorspreaders	OEM parts	Falcon	All	1y
PTO shafts		Imported	All	1y	
Limespreaders	OEM parts	Falcon	All	1y	
Bale forks + beams	OEM parts	Falcon	All	1y	
Unloaders®	OEM parts	Falcon	All	1y	
Bale Grab	OEM parts	Falcon	All	1y	
Amazone	Spreaders Sprayers Soil Tillage Turf equipment	All	Amazone	All	1y

## PRODUCT RANGE

The Falcon range of material handling implements is a selection of tractor- and telehandler-mounted products intended primarily for the handling of hay bales and bulk bags.

The Uniloader® models are also equipped with a utility lifting hook for general lifting tasks.

### > Bale forks

Dedicated hay bale forks.

- For direct 3-point mounting.
- Loading heights up to 2 700 mm.

### > Unloaders®

A range of universal loaders.

- Payload capacities of 750 and 1 000 kg.
  - Lifting heights up to 4 500 mm.
- 1 000 kg versions available with a selection of attachments:
- Dedicated hay bale fork.
  - Bulk bag handler with cruciform spreader bar.

### > Bale Grab

Versatile bale handler with a large capacity.

- Max. payload capacity of 2 200 kg (3 x Big Pack bales).
- Loading height depends on telehandler.

## PRODUKREEKS

Die Falcon-reeks materiaalhanteringsimplemente is 'n seleksie trekker- en telehandler-gemonteerde produkte wat hoofsaaklik vir die hantering van hooibale en grootmaatsakke ontwerp is.

Die Uniloader®-modelle is ook toegerus met 'n nuttige haak vir algemene opligtake.

### > Baalvurke

Toegewyde hooibaalvurke.

- Vir direkte 3-punt-montering.
- Laaihoogtes van tot 2 700 mm.

### > Unloaders®



'n Reeks universele of algemene laaiers.

- Loonvragkapasiteite 750 and 1 000 kg.
  - Hyshoogtes tot 4 500 mm.
- 1 000 kg-modelle beskikbaar met 'n verskeidenheid hegstukke:
- Toegewyde hooibaalvurk.
  - Grootmaatsakhanteerder met kruisvormige raam.

### > Bale Grab

Veelsydige baalhanteerder met 'n groot kapasiteit.

- Maks loonvragkapasiteit van 2 200 kg (3 x Big Pack bale).
- Laaihoogte hang af van telehandler.

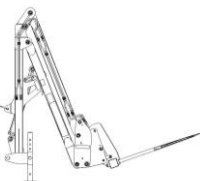
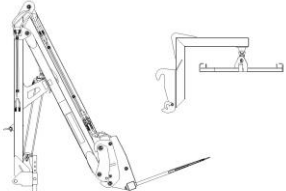
Profile	Model / (Part no.)	Payload max. <sup>(1)</sup> (kg)	Lift height <sup>(2)</sup> (mm)	W x L x H <sup>(3)</sup> (mm)			Mass (kg)
	Bale fork (A7111)	750	n/a	995	1 220	620	48
	Bale fork loader (A7101)	750	2 700	995	3 730	1 050	144
	Uniloader® F750 (A7500 & A7501)	750	3 400	960	2 380	2 120	323
	Uniloader® F1000 (A7502–A7506)	1 000	4 500	960	2 680	2 650	565

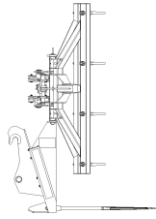
Profile	Model / (Part no.)	Payload max. <sup>(1)</sup> (kg)	Lift height <sup>(2)</sup> (mm)	W x L x H <sup>(3)</sup> (mm)			Mass (kg)
	Bale Grab F2250  (A7525)	2200	n/a	1690	1610	2290	505
Model	Model / (Onderdeelnr.)	Loonvrag maks. <sup>(1)</sup> (kg)	Hys hoogte <sup>(2)</sup> (mm)	B x L x H <sup>(3)</sup> (mm)			Massa (kg)
<b>Notes:</b> <sup>(1)</sup> With bale spikes fully inserted in hay bale. <sup>(2)</sup> Measured from tractor lower hitch pin to the bale spike or hook centre line (Bale forks and Unloaders®), OR dependant on telehandler arm range (Bale Grab). <sup>(3)</sup> In rest position; implement fully lowered/closed.			<b>Notas:</b> <sup>(1)</sup> Met baalpenne volledig in hooibale ingedruk. <sup>(2)</sup> Afhanklik van trekkerhaakontwerp en -hoogte; gemeet vanaf trekker se onderste haakpen tot by die baalpen of haakmiddellyn (Baalvurke en Unloaders®), OF afhanklik van telehandler-reikafstand (Bale Grab). <sup>(3)</sup> In rusposisie; implement ten volle laat sak/toegemaak.				



## INSTALLATION

### Attaching the implement to the tractor (Bale Forks and Unloaders®) or telehandler (Bale Grab)

- ⚠ Do not enter the area between the power machinery and the implement unless the power machinery engine has been shut off, the handbrake applied, and the key removed from the ignition.
- ⚠ Use only hitch pins and lynchpins of the correct specification, such as those provided with the implement.

The Bale Forks and Unloaders® are intended to be attached to tractors equipped with a standard 3-point agricultural hitch.

- ⊖ Note that the Bale Fork Loader does NOT require the use of the tractor top link.
- ✔ Once the implement is hitched to the tractor, lift it to an acceptable transportation height, ensuring that there is no contact between the implement and any part of the tractor.
- ✔ Adjust the tractor 3-point hitch stabiliser arms to ensure stability of the implement while working and during transportation.
- ✔ Set the tractor hitch lift arms to a fixed, non-floating position to ensure stability of the implement while working and during transportation.

The Bale Grab is intended to be attached to the tool carrier of a telehandler.

- ✔ Engage the top pins of the telehandler tool carrier with the hitch plates mounted at the rear of the Bale Grab.
- ✔ Adjust the positions of the hitch plates as necessary to ensure a close fit with the tool carrier.
- ✔ Raise the tool carrier slightly to tilt the implement forward, aligning the retracted lower pins on the tool carrier with the hitch plate bushes.
- ✔ Extend the tool carrier's lower quick coupler pins, ensuring full engagement through the hitch plate bushes.

### Settings and adjustment

- ⚠ Do not perform maintenance or any other work on the implement unless the power machinery engine has been shut off, the handbrake applied, and the key removed from the ignition.
- ⚠ Do not perform maintenance or any other work on the implement while it is suspended on only the power machinery hitch, and without suitable additional support for the implement.

Careful attention should be paid to the working angle of the implement bale spikes. These should be in a horizontal position at the height at which the hay bale is to be penetrated (Fig. 1-H / 2-H).

## INSTALLERING

### Koppel van die implement aan die trekker (Baalvurke en Unloaders®) of telehandler (Bale Grab)

- ⚠ Moenie tussen die kragmasjinerie en die implement inbeweeg tensy die kragmasjinerie-enjin afgeskakel, die handrem opgetrek en die sleutel uit die aansitter verwyder is nie.
- ⚠ Gebruik slegs haak- en lunspeen met die korrekte spesifikasies, soos dié wat saam met die implement verskaf is.

Die Baalvurke en Unloaders® is bedoel om aan trekkers te koppel wat met 'n standaard-3-punt-trekkerhaak toegerus is.

- ⊖ Let daarop dat die Baalvurklaaier NIE die gebruik van die trekker se boskabel vereis nie.
- ✔ Nadat die implement aan die trekker gehaak is, lig dit tot 'n aanvaarbare vervoerhoogte; verseker dat daar geen kontak tussen die implement en enige deel van die trekker is nie.
- ✔ Verstel die trekker se 3-punt-haak-stabiliseerderarms om stabiliteit van die implement tydens die bedryf en vervoer daarvan te verseker.
- ✔ Stel die trekkerhaakhysarms in 'n vaste, nieswewende posisie om stabiliteit van die implement tydens die bedryf en vervoer daarvan te verseker.

Die Bale Grab is bedoel om aan die gereedskapdraer van 'n telehandler geheg te word.

- ✔ Koppel die boonste penne van die telehandler gereedskapdraer met die koppelplate wat aan die agterkant van die Bale Grab gemonteer is.
- ✔ Verstel die posisies van die koppelplate soos nodig om 'n noue passing met die gereedskapdraer te verseker.
- ✔ Lig die gereedskapdraer effens op om die implement vorentoe te kantel, en bring die teruggetrekte onderste penne op die gereedskapdraer in lyn met die koppelplaatbusse.
- ✔ Strek die gereedskapdraer se onderste koppelpenne uit, om volle koppeling deur die koppelplaatbusse te verseker.

### Instellings en verstelling

- ⚠ Moenie enige instandhouding- of ander werk aan die implement doen tensy die kragmasjinerie-enjin afgeskakel, die handrem opgetrek en die sleutel uit die aansitter verwyder is nie.
- ⚠ Moenie enige instandhouding- of ander werk aan die implement uitvoer terwyl dit slegs aan die kragmasjinerie se 3-punt-haak hang sonder enige bykomende steun vir die implement nie.

Daar moet noukeurig aandag gegee word aan die werkshoek van die implement se baalpenne. Hierdie moet in 'n horisontale posisie wees op die hoogte waarop die hooibaal gepentreer moet word (Fig. 1-H / 2-H).

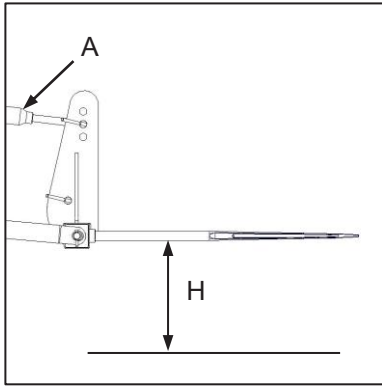

Fig. 1

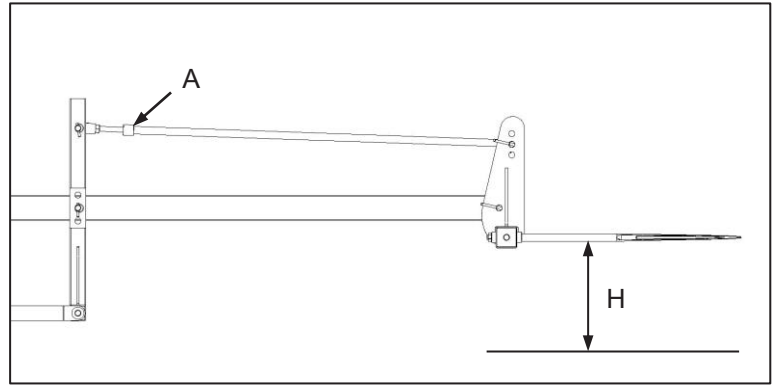

Fig. 2

➤ **Bale fork and Bale fork loader**

- ✔ To set the working angle of the bale spikes, adjust the length of the tractor hitch top link (Bale fork, Fig. 1-A) or length of the implement tie-rod (Bale fork loader, Fig. 2-A).

➤ **Unloaders® and Bale Grab**

- ✔ The implement frame must be set to a vertical position once lifted to the anticipated working height. This is accomplished by adjusting the length of the tractor hitch top link (Unloader®, Fig. 3-A) or the tilt of the telehandler's tool carrier (Fig. 4).
- ⊖ The working angle of the bale spikes is accomplished hydraulically – refer to OPERATION elsewhere in this manual.

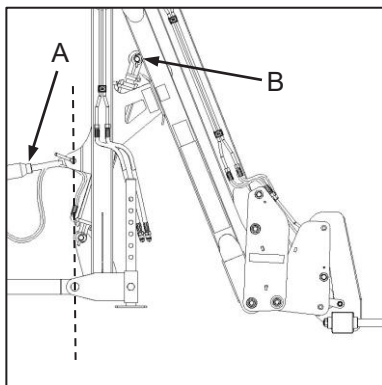

Fig. 3

➤ **Baalvurk**

- ✔ Om die werkshoek van die baalpenne te stel, verstel die lengte van die trekkerhaak se boskakeel (Fig. 1-A).

➤ **Unloaders® en Bale Grab**

- ✔ Die implementraam moet in 'n vertikale posisie gestel word sodra dit tot die verwagte werkhoopte opgelig is. Dit word bewerkstellig deur die lengte van die bo-arm van die trekker te verstel (Unloader®, Fig. 3-A) of die kanteel van die telehandler se gereedskapdraer aan te pas (Fig. 4).
- ⊖ Die werkshoek van die baalpenne word hidroulies gestel – verwys na BEDRYF elders in hierdie handleiding.

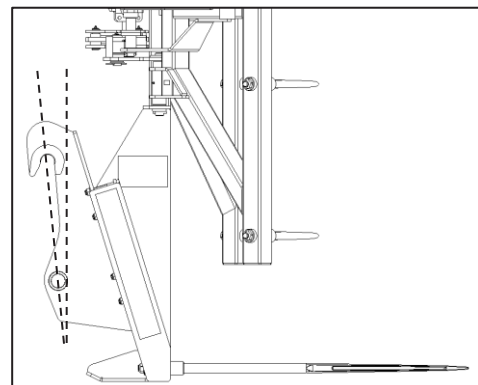

Fig. 4

**Lubrication and oil levels**

- ✔ Apply grease at all the grease nipples provided (all models).
- ✔ On Unloader® models, ONLY the upper clevis spherical bearing (Fig. 3-B) requires greasing before use. The rest of the articulation points contain maintenance-free, self-lubricating bushes.
- ⊖ For lubrication requirements, refer to MAINTENANCE, Table 2, Lubrication requirements.

**Smering en olievlakke**

- ✔ Ghries al die ghriesnippels wat voorsien word (alle modelle).
- ✔ Op Unloader®-modelle benodig SLEGS die boonste sferiese laer (Fig. 3-B) ghries voor gebruik. Die res van die artikulatiepunte bevat onderhoudsvrye, selfsmerende busse.
- ⊖ Vir smeringvereistes, verwys na INSTANDHOUDING, Tabel 2, Smeringvereistes.

## OPERATION

## BEDRYF

### General

It is the responsibility of the owner to ensure that the operation of agricultural power machinery and any attached equipment is carried out in accordance with all applicable laws, regulations and practices relating to safe and responsible operation.

- Applicable regulations should include but not be limited to the South African Occupational Health and Safety Act No. 83 of 1993 and the South African National Road Traffic Act No. 93 of 1996.
- Refer also to operational information relevant to the tractor concerned, including handbooks, operator manuals, and safety and warning notices and decals.

### Preparation for use

- ▲ Only suitably trained persons should operate the implement and no person should operate the implement without first studying and establishing a complete understanding of the content of this manual.

The implement should be thoroughly inspected and prepared before each use and with reference to procedures described elsewhere in this manual.

1. Attaching the implement to the power machinery.
2. Settings and adjustments.
3. Routine maintenance (before and after each use).

Inspect the work area.

- Remove any movable obstructions from the work area.
- Note the presence of ditches, holes, stumps, stones, rocks, or any other obstruction that might destabilise the power machinery or cause damage to the implement. Remove these obstacles where possible, otherwise note and avoid these areas during cutting.

### Operating the implement

- ▲ Never approach or allow any person to approach the implement unless the implement has been lowered to the ground, the power machinery engine has been shut off, the handbrake applied, and any hydraulically operated facilities have been returned to a safe resting position.
- ▲ Actively discourage spectators and cease operation of the implement if any person approaches or enters the work area.
- ▲ In the case of hydraulically operated equipment, be sure to operate the implement only at the specified hydraulic pressures.

### Algemeen

Dit is die verantwoordelikheid van die eienaar om te verseker dat die bedryf van landbou-kragmasjinerie en enige gekoppelde toerusting uitgevoer word in ooreenstemming met alle toepaslike wette, regulasies en praktyke wat met veilige en verantwoordelike bediening te doen het.

- Toepaslike regulasies sluit in, maar is nie beperk nie tot, die Suid-Afrikaanse Wet op Beroepsgesondheid en Veiligheid nr. 85 van 1993 en die Suid-Afrikaanse Wet op Nasionale Padverkeer nr. 93 van 1996.
- Verwys ook na bedryfsinligting oor die betrokke trekker, insluitend handboeke, operateurshandleidings en veiligheid- en waarskuwingskennisgewings en -plakkers.

### Voorbereiding vir gebruik

- ▲ Slegs toepaslik opgeleide persone moet die implement bedryf, en geen persoon moet dit bedryf sonder om eers die inhoud van hierdie handleiding te bestudeer en 'n volledige begrip daarvan te verkry nie.

Die implement moet telkens eers deeglik geïnspekteer en voorberei word voor dit gebruik word en met verwysing na prosedures wat in ander dele van hierdie handleiding beskryf word.

1. Koppeling van die implement aan die kragmasjinerie.
2. Instellings en verstellings.
3. Roetine-instandhouding (voor en na elke gebruik).

Inspekteer die werksgebied.

- Verwyder enige los obstrukties van die werksgebied.
- Let op enige dongas, gate, stompe, klippe, rotse of enige ander obstruksie wat die kragmasjinerie mag destabiliseer of die implement kan beskadig. Verwyder hierdie hindernisse waar moontlik, of anders moet hierdie gebiede gedurende sny vermy word.

### Bedryf van die implement

- ▲ Moet nooit na die implement beweeg, of toelaat dat enigiemand anders dit doen, tensy die implement op die grond laat sak is, die kragmasjinerie-enjin afgeskakel is, die handrem opgetrek is en enige hidroulies-beheerde geriewe tot 'n veilige rusposisie herstel is nie.
- ▲ Toeskouers moet aktief ontmoedig word en bedryf van die implement moet onmiddellik gestaak word as enige persoon die werksgebied benader of dit betree.
- ▲ In die geval van hidroulies-beheerde toerusting, verseker dat die implement telkens slegs teen die gespesifiseerde hidrouliese druk bedryf word.

- Failure to operate the implement at the specified hydraulic pressures can result in unsafe operating conditions as well as structural and mechanical failure not covered under warranty.

### The bale handling process

The following procedures are recommended for the piercing, lifting, transporting and off-loading/stacking of hay bales.

#### > All models

- ✔ Ensure that the bale spikes are in a horizontal position before engaging the hay bale.
- ✔ Select a low gear on the power machinery and slowly allow the bale spikes to penetrate the hay bale.
- ✔ The hay bale should be fully penetrated – with the face of the bale in contact with the fork frame.
- ✔ To extract the bale spikes from the hay bale, place the bale in position on the ground (or loading surface), and travel away using a low gear.

- Failure to operate the implement within the specified maximum lifting capacity can result in unsafe operating conditions as well as structural and mechanical failure not covered under warranty.

#### > Unloaders®

In addition to the above:

- ✔ Always return these implements to the rest position before transporting hay bales over extended distances (Fig. 1).
- ✔ In cases where hay bales are being transferred to other equipment (such as hoppers, shredders or feed mixers), the head of the Uniloader® should be tilted downwards to assist with the ejection of the hay bale (Fig. 2).

- Failure to observe transport requirements can result in structural and mechanical failure not covered under warranty.

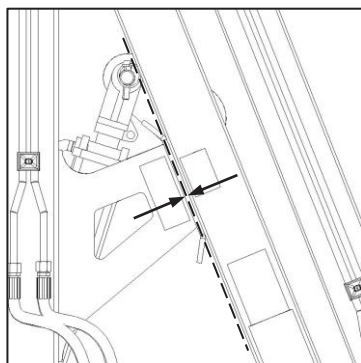

Fig.1

- Versuim om die implement teen die gespesifiseerde hidrouliese druk te bedryf kan tot onveilige bedryfstoe-stande lei, asook tot strukturele en meganiese onklaarraking wat nie deur die waarborg gedek word nie.

### Die baalhanteringsproses

Die volgende prosedures word vir die penetrasie, hysing, vervoer en aflaai/stapeling van hooibale aanbeveel.

#### > Alle modelle

- ✔ Verseker dat die baalpenne horisontaal is voordat hulle in die hooibaal ingesteek word.
- ✔ Sit die kragmasjinerie in 'n lae trurat en laat die baalpenne die hooibaal stadig deurpriem.
- ✔ Die baal moet volledig deurboor word, met die gesig van die baal teen die vurkraam.
- ✔ Om die baalpenne uit die baal te onttrek, plaas die baal in posisie op die grond (of laaioppervlak) en ry in 'n lae rat weg.

- Versuim om die implement binne die gespesifiseerde maksimum hysvermoë te bedryf kan tot onveilige bedryfstoe-stande lei, asook tot strukturele en meganiese onklaarraking wat nie deur die waarborg gedek word nie.

#### > Unloaders®

Bykomend tot die bostaande:

- ✔ Herstel hierdie implemente altyd tot die rusposisie voordat die bale oor lang afstande vervoer word (Fig. 1).
- ✔ In gevalle waar die bale na ander toerusting oorgeplaas word (soos bakke, kerwers of voermengers), moet die kop van die Uniloader® afwaarts gekantel word om met die aflaai van die baal te help (Fig. 2).

- Versuim om vervoervereistes na te kom kan tot strukturele en meganiese onklaarraking lei wat nie deur die waarborg gedek word nie.

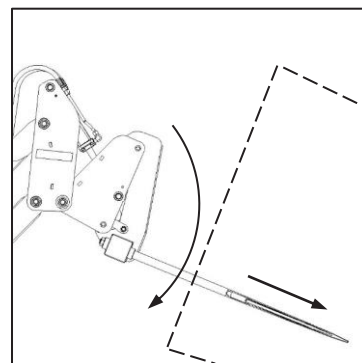

Fig. 2

## Attachments

- Both the F750 and F100 ranges of Uniloader® are available with detachable bale fork heads (Fig. 3).
- The F1000 Uniloader® model may also be equipped with a hook attachment for general lifting tasks, plus a cruciform spreader for the handling of agricultural bulk bags (Fig. 4).

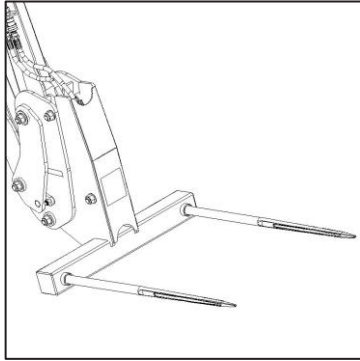

Fig.3

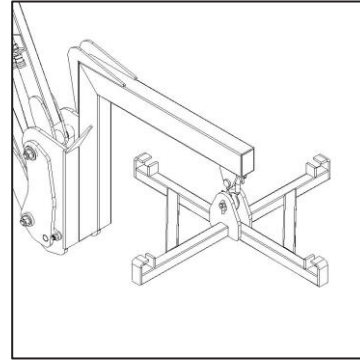

Fig. 4

Similar procedures should be followed for installing the chosen attachment.

- ✔ Hook the chosen attachment on to the upper support bar of the boom front mounting bracket (Fig. 5-A).
- ✔ With the safety latches retracted (Fig. 6-A), lower the attachment on to the lower support bar (Fig. 6-B).
- ✔ Apply the safety latches (Fig. 7-A).

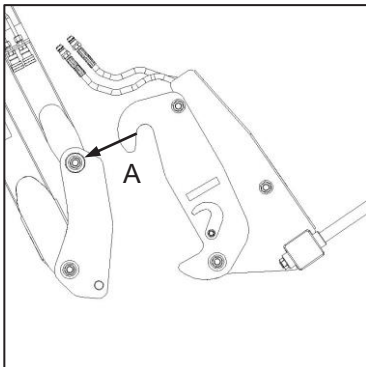

Fig. 5

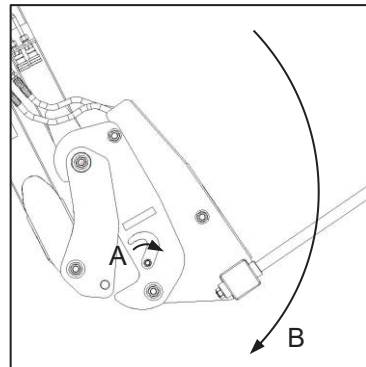

Fig. 6

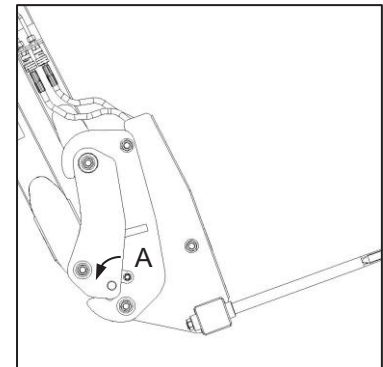

Fig. 7

Soortgelyke prosedures moet vir die installering van die gekose hegstuk gevolg word.

- ✔ Haak die gekose hegstuk aan die boonste steunbalk van die voorste balkmonteersteunstuk (Fig. 5-A).
- ✔ Met die veiligheidsknippe teruggetrek (Fig. 6-A), laat die hegstuk tot op die onderste steunbalk sak (Fig. 6-B).
- ✔ Skuif die veiligheidsknippe weer in posisie (Fig. 7-A).

## > Bale Grab

- ✔ To ensure smooth engagement with a bale stack, the wings should be fully open such that the tips of the curved bale forks point straight forward (Fig. 8).
- ✔ After penetrating a bale stack, ensure the wings are closed as far as possible – transporting hay bales with partially engaged wings pose a safety risk (Fig. 9).
- ✔ Always lower the implement to a reasonable height when transporting hay bales over an extended distance, while maintaining visibility from the telehandler cabin.
- Failure to observe transport requirements can result in structural and mechanical failure not covered under warranty.

## > Bale Grab

- ✔ Om gladde koppeling met 'n baalstapel te verseker, moet die vlerke heeltemal oop wees sodat die punte van die geboë baalvurke reguit vorentoe wys (Fig. 8).
- ✔ Nadat 'n baalstapel binnegedring is, maak seker dat die vlerke so ver moontlik gesluit is - die vervoer van hooibale met gedeeltelik vasgemaakte vlerke hou 'n veiligheidsrisiko in (Fig. 9).
- ✔ Laat sak altyd die implement tot 'n redelike hoogte wanneer hooibale oor 'n lang afstand vervoer word, terwyl sigbaarheid vanaf die telehandlerkajuit behou word.

Versuim om vervoereistes na te kom, kan lei tot strukturele en meganiese foute wat nie onder waarborg gedek word nie.

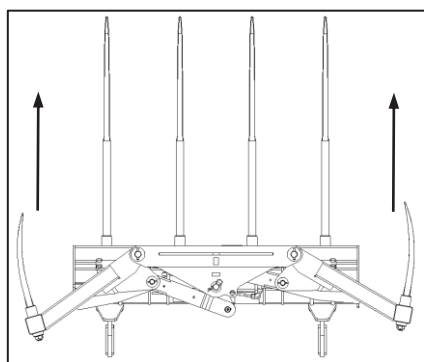

Fig. 8

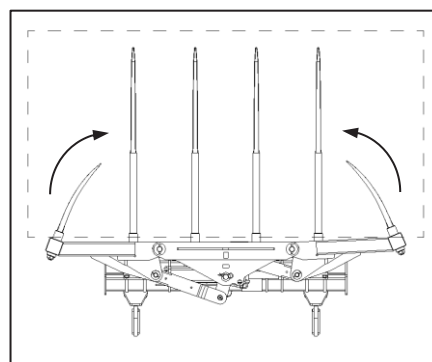

Fig.9

## Hydraulic controls

### > Unloaders®

Boom lifting and head articulation are accomplished hydraulically.

- ✔ Attach the hydraulic hoses to the tractor auxiliary control valves, with reference to the colour-coded labels applied to the hoses and the colour code reference decal provided on the implement.
- ⊖ The hydraulic circuit on this implement is intended to operate at a working pressure of 180 bar and a maximum relief pressure of 200 bar. It is the responsibility of the owner to ensure that these conditions are met as failure to do so will result in failures and damage not covered under warranty.
- ⊖ Be sure to observe flow directions and connector colour codes when coupling the hydraulic hoses to the tractor auxiliary control valves, as failure to do so will result in failures and damage to hydraulic components not covered under warranty.

### > Bale Grab

Frame articulation and levelling are accomplished hydraulically.

- ✔ To couple the hydraulic circuit, ensure the pressure on the telehandler hydraulic connections are released by switching the engine off, and moving the hydraulic control lever back and forth several times.
- ✔ Couple the hydraulic connections of the implement to the openings of the hydraulic connections on the telehandler boom.
- ✔ To uncouple, once again ensure the pressure on the telehandler hydraulic connections are released and remove the implement hydraulic connections from the telehandler.
- ⊖ Be sure to observe flow directions when coupling the hydraulic hoses to the ports on the telehandler. Failure to do so may result in failures and damage to hydraulic components not covered under warranty.

## Hidrouliese kontroles

### > Unloaders®

Balkhoogteverstelling en kopartikulasie word hidroulies bewerkstellig.

- ✔ Heg die hidrouliese pype aan die trekker se hulp-beheerleppe, met verwysing na die kleurgekodeerde etikette aan die pype en die kleurkodeverwysingsplakker op die implement.
- ⊖ Hierdie implement se hidrouliese stelsel is ontwerp om teen 'n druk van 180 bar en 'n maksimum ontlastingsdruk van 200 bar te werk. Die eienaar moet verseker dat hierdie voorwaardes nagekom word, aangesien versuim om dit te doen sal lei tot onklaarraking en skade wat nie deur die waarborg gedek word nie.
- ⊖ Verseker dat vloeirigtings en koppelingkleurkodes korrek is by koppeling van die hidrouliese pype aan die trekker se hulpbeheerleppe; versuim om dit te doen sal lei tot onklaarraking en skade aan hidrouliese komponente wat nie deur die waarborg gedek word nie.

### > Bale Grab

Raamartikulasie en gelykmaking word hidroulies bewerkstellig.

- ✔ Om die hidrouliese stelsel te koppel, maak seker dat die druk op die telehandler se hidrouliese konneksies vrygestel word deur die enjin af te skakel en die hidrouliese beheerhefboom verskeie kere heen en weer te beweeg.
- ✔ Koppel die hidrouliese konneksies van die implement aan die openinge van die hidrouliese konneksies op die telehandlerbalk.
- ✔ Om te ontkoppel, maak weereens seker dat die druk op die telehandler se hidrouliese konneksies vrygestel word en verwyder die implement se hidrouliese konneksies vanaf die telehandler.

Maak seker om vloeirigtings waar te neem wanneer die hidrouliese pype aan die poorte op die telehandler gekoppel word. Versuim om dit te doen, kan lei tot mislukkings en skade aan hidrouliese komponente wat nie onder waarborg gedek word nie.

## Transportation and storage

These implements may be transported on the power machinery hitch between work sites.

- ✔ Ensure that the implement is lifted to a suitable height to clear any obstacles and parking stands are fully retracted.
- ✔ Adjust stabilisers on the tractor hitch to prevent excessive lateral sway and possible contact with the tractor tyres.
- ✔ Maintain a speed low enough to prevent excessive bouncing and resultant damage to mounting points and other load-bearing components.

### > Unloaders®

When parking the implement (and before unhitching), the parking stands should be set to a convenient height (Fig. 10-A) for future re-hitching (Fig. 10-B).

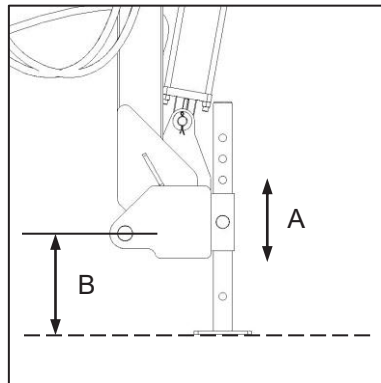

Fig. 10

### > Bale Grab

When parking the implement, ensure that the surface is level and that the wings are in the closed position (Fig. 11). This storage configuration maximizes the stability of the implement, by positioning the mass of the wings over the lower spikes.

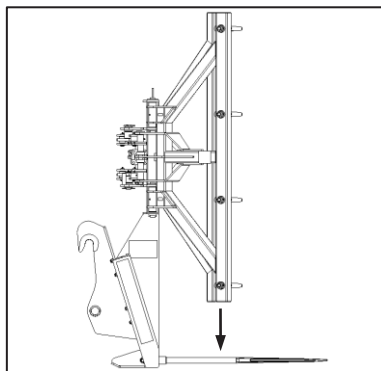

Fig. 11

## Vervoer en berging

Hierdie implemente kan tussen werksterreine aan die kragmasjinerie se 3-punt-haak vervoer te word.

- ✔ Verseker dat die implement tot op 'n gepaste hoogte gelig word om vrylik oor enige hindernisse te kan beweeg en dat parkeerstutte ten volle opgelig is.
- ✔ Verstel stabiliseerders aan die trekkerhaak om oormatige laterale beweging en moontlike kontak met die trekker se bande te verhoed.
- ✔ Handhaaf 'n spoed wat laag genoeg is om oormatige borsing en gevolglike skade aan monteerpunte en ander lasdraende komponente te verhoed.

### > Unloaders®

Wanneer die implement geparkeer word (en voor dit afgehaak word), stel die parkeerstutte op 'n gemaklike hoogte (Fig. 10-A) vir toekomstige aanhaak (Fig. 10-B).

## MAINTENANCE

### Routine maintenance

- ⚠ Do not perform maintenance or any other work on the implement unless the power machinery engine has been shut off, the handbrake applied, and the key removed from the ignition.
- ⚠ Do not perform maintenance or any other work on the implement while it is suspended on only the power machinery hitch, or without suitable additional support for the implement.
- ⚠ Use only original and approved Falcon replacement parts and lubricants. Refer to the parts information provided in this manual.

Maintenance should be carried out before and after each use and in accordance with the schedules provided in this chapter.

- Bolted connections should be checked for tightness with reference to Bolt Torque Specifications (Table 1).

#### ➤ BEFORE and AFTER each use

To be carried out at least daily in periods of continuous use. Otherwise before each occasion that the implement is used. Extra care and attention should be given to implements which may have been unused for prolonged periods (longer than 1 month).

- ✔ Check all fasteners for tightness. This includes special attention to safety-critical fasteners such as pivot pin retaining nuts (Fig. 1-A), hitch plate retaining bolts (Fig. 2-D), and bale spike mounting points (Fig. 1-C / 2-C / 3-B) – see Bale Spike Fitting elsewhere in this section.
- ✔ Inspect all pivot points for indications of wear and replace pivot bushes when excessive play is detected.

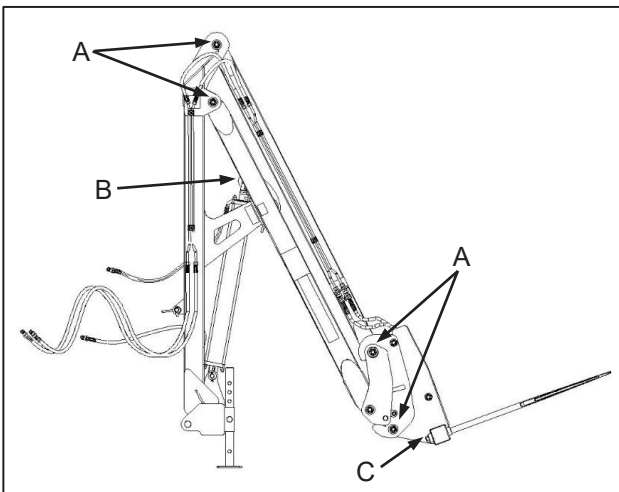

Fig. 1

## INSTANDHOUDING

### Roetine-instandhouding

- ⚠ Moenie instandhouding- of enige ander werk aan die implement doen tensy die kragmasjinerie-enjins afgeskakel, die handrem opgetrek en die sleutel uit die aansitter verwyder is nie.
- ⚠ Moenie instandhouding- of enige ander werk aan die implement doen terwyl dit net aan die kragmasjinerie se 3-punt-haak hang, of sonder geskikte ekstra stutte vir die implement nie.
- ⚠ Gebruik slegs oorspronklike en goedgekeurde Falcon-vervangingsonderdele en smeermiddels. Verwys na die onderdele-inligting in hierdie handleiding.

Instandhouding moet telkens voor en na gebruik gedoen word, en in ooreenstemming met die skedules wat in hierdie hoofstuk vervat is.

- Verseker dat koppelboute in ooreenstemming met die boutwringkragspesifikasiekaart vas is (Tabel 1).

#### ➤ VOOR en NA elke gebruik

Word ten minste daagliks in tye van deurlopende gebruik uitgevoer. Anders voor elke keer dat die implement gebruik word. Gee ekstra sorg en aandag aan implemente wat dalk vir lang tydperke (meer as 1 maand) nie gebruik is nie.

- ✔ Verseker dat alle hegstukke vas is. Dit sluit in spesiale aandag aan veiligheidskritieke hegstukke soos spilpenkeermoere (Fig. 1-A), koppelplaat-klemboute (Fig. 2-D) en baalpenmonteerpunte (Fig. 2-C / 3-B) – kyk Baalpenmontering elders in hierdie afdeling.
- ✔ Inspekteer alle spilpunte vir tekens van slytasie en vervang spilbusse waneer oormatige speling waargeneem word.

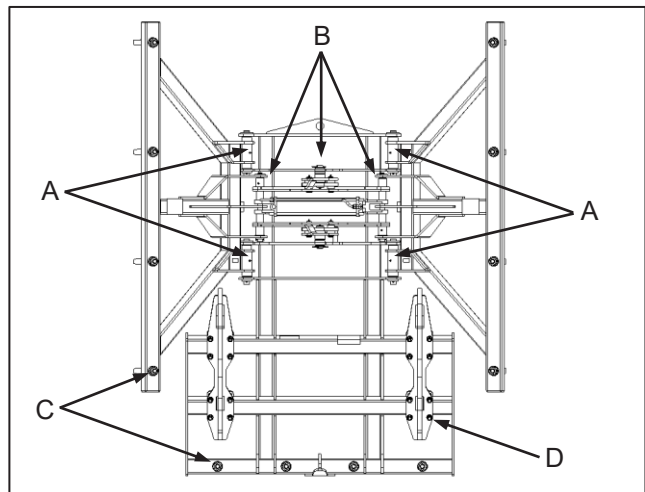

Fig. 2



- ✔ Inspect all hitch mounting pins and hydraulic cylinder mounting pins for signs of wear.
- ✔ Check that all secondary securing mechanisms such as lynchpins, split-pins, and clips are in place.
- ✔ On Uniloader® models, ONLY the upper clevis spherical bearing (Fig. 1-B) requires greasing before use. The rest of the articulation points contain maintenance-free, self-lubricating bushes.
- ✔ On the Bale Grab, apply lubrication to all supplied grease nipples (Fig. 2-A / 2-B).

### Bale spike fitting

Special attention should be given to the bale spikes and mounting points (Fig. 1-C).

- ✔ Check bale spikes and mounting bushes (Fig. 3-A) for signs of distortion, cracking or breakages. In the event of any observed defect do NOT attempt a repair, but immediately replace the defective item, complete with retaining nut. Ensure that the bale spike is correctly orientated before tightening (Fig. 4).
- ✔ Ensure that the bale spike mounting nut (Fig. 3-B) is tightened to the specified torque.

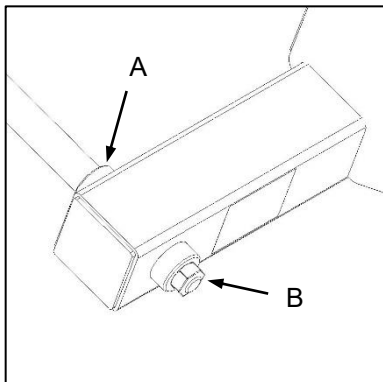

Fig. 3

- ⊖ All applications: Bale spike mounting nut tightening torque = 450 N.m.
- ⊖ Note that failure to observe this procedure may result in premature wear of the bale spike mounting bushes (Fig. 3-A), necessitating replacement of the complete welded assembly containing the mounting bushes.

- ✔ Inspekteer alle haakmonteringspinne en hidrouliese silindermonteringspinne vir tekens van slytasie.
- ✔ Kontroleer dat alle sekondêre veiligheidsmeganismes soos luspinne, splitpinne en knippies in plek is.
- ✔ Op Uniloader®-modelle benodig SLEGS die boonste sferiese laer (Fig. 1-B) ghries voor gebruik. Die res van die artikulaspunte bevat onderhoudsvrye, selfsmerende busse.
- ✔ Ghries alle verskafde ghriesnippels (Fig. 2-A / 2-B) op die Bale Grab.

### Baalvurkmontering

Spesiale aandag moet aan die baalpinne en monteerpunte geskenk word (Fig. 1-C).

- ✔ Gaan baalpinne en monteringsbusse (Fig. 3-A) na vir tekens van verwringing, krake of brekasie. Indien enige defek opgemerk word, MOET dit NIE probeer herstel nie, maar vervang die defekte item onmiddellik, asook die keermoer. Verseker dat die baalpin korrek georiënteer is voor dit vasgedraai word (Fig. 4).
- ✔ Verseker dat die baalpinmonteringsmoer (Fig. 3-B) volgens die gespesifiseerde wringkrag vasgedraai word.

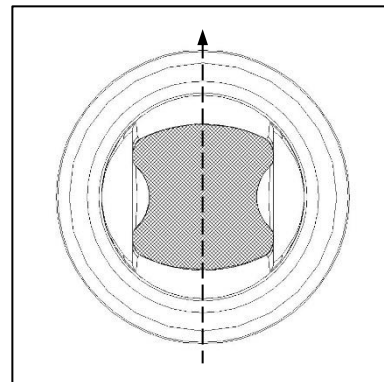

Fig. 4

- ⊖ Alle toepassings: Wringkrag vir baalpinmonteringsmoer = 450 N.m.
- ⊖ Let daarop dat versuim om hierdie prosedure te volg, tot voortydige slyting van die baalpinmonteringsbusse (Fig. 3-A) kan lei, wat die vervanging van die hele gelaste samestelling wat die monterbusse bevat, noodsaak.

**Table/Tabel 1**

Bolt Torque Specifications (N.m) / Boutwringkragspesifikasies (N.m)

Class/Klas	4.6		8.8		10.9		12.9	
	Wet/Nat	Dry/Droog	Wet/Nat	Dry/Droog	Wet/Nat	Dry/Droog	Wet/Nat	Dry/Droog
M6	4,8	6	9	11	13	17	15	19
M8	12	15	22	28	32	40	37	47
M10	23	29	43	55	63	80	75	95
M12	40	50	75	95	110	140	130	165
M14	63	80	120	150	175	225	205	260
M16	100	125	190	240	275	350	320	400
M18	135	175	260	330	375	475	440	560
M20	190	240	375	475	530	675	625	800
M22	260	330	510	650	725	925	850	1 075
M24	330	425	650	825	925	1 150	1 075	1 350
M27	490	625	950	1 200	1 350	1 700	1 600	2 000
M30	675	850	1 300	1 650	1 850	2 300	2 150	2 700
M33	800	1 150	1 750	2 200	2 500	3 150	2 900	3 700
M36	1 150	1 450	2 250	2 850	3 200	4 050	3 750	4 750

**Table/Tabel 2**

Lubrication Requirements / Smeringvereistes

Application/Toeassing		Type/Tipe	Process/Proses	Interval	Products/Produkte
<b>Gearboxes</b> Ratkaste	<b>Bevel gearboxes</b> Keëlratkaste	<b>Oiled/Geolie</b>	<b>Replace/Vervang</b>	12 m	<b>Gear oil, Fuchs, Renep 1000</b> Ratkasolie, Fuchs, Renep 1000
			<b>Check/Gaan na</b>	1 d	
	<b>Splitter gearboxes</b> Verdeelratkaste	<b>Oiled/Geolie</b>	<b>Replace/Vervang</b>	12 m	
			<b>Check/Gaan na</b>	1 d	
<b>PTO driveshafts</b> Kragaftakkerasse	<b>UV-joints</b> Kruiskoppelings	<b>Greased/Geghries</b>	<b>Refresh/Vul aan</b>	10 h/u	<b>Grease, Universal, Moly #2</b> Ghries, Algemeen, Moly #2
	<b>CV-joints</b> KS-koppelings	<b>Greased/Geghries</b>	<b>Refresh/Vul aan</b>	10 h/u	
	<b>Telescopic tubes</b> Teleskopiese buise	<b>Greased/Geghries</b>	<b>Refresh/Vul aan</b>	20 h/u	
<b>Auxiliary drives</b> Hulpaandrywings	<b>Intermediate shafts</b> Intermediêre tussenasse	<b>Greased/Geghries</b>	<b>Refresh/Vul aan</b>	10 h/u	<b>Grease, Fuchs, HT Lithium M2</b> Ghries, Fuchs, HT Lithium M2
	<b>Spindles</b> Spille	<b>Greased/Geghries</b>	<b>Replace/Vervang</b>	12 m	
			<b>Refresh/Vul aan</b>	10 h/u	
	<b>Bearing housings</b> Koeëllaeromhulsels	<b>Greased/Geghries</b>	<b>Replace/Vervang</b>	3 m	
<b>Refresh/Vul aan</b>			10 h/u		
<b>Bearing units</b> Koeëllaareenhede	<b>Greased/Geghries</b>	<b>Refresh/Vul aan</b>	20 h/u	<b>Grease, Universal, Moly #2</b> Ghries , Algemeen, Moly #2	
<b>Wheels</b> Wiele	<b>Wheel bearings</b> Wielkoeëllaers	<b>Greased/Geghries</b>	<b>Refresh/Vul aan</b>		1 w
<b>Pivot points</b> Spilpunte	<b>Pins and bushes</b> Penne en busse	<b>Greased/Geghries</b>	<b>Refresh/Vul aan</b>	10 h/u	<b>Machine oil, Universal</b> Masjienolie, Algemeen
		<b>Oiled/Geolie</b>	<b>Refresh/Vul aan</b>	10 h/u	<b>Grease, Universal, Moly #2</b> Ghries , Algemeen, Moly #2
	<b>Ball joints</b> Koeëlgewrigte	<b>Greased/Geghries</b>	<b>Refresh/Vul aan</b>	10 h/u	<b>Machine oil, Universal</b> Masjienolie, Algemeen
		<b>Oiled/Geolie</b>	<b>Refresh/Vul aan</b>	10 h/u	<b>Machine oil, Universal</b> Masjienolie, Algemeen
<b>Adjusters/Levers</b> Verstellers/Hefbome	<b>Threaded rods/ Leadscrews</b> Skroefdraadstawe/ Leiskroewe	<b>Greased/Geghries</b>	<b>Refresh/Vul aan</b>	20 h/u	<b>Grease, Universal, Moly #2</b> Ghries , Algemeen, Moly #2
		<b>Oiled/Geolie</b>	<b>Refresh/Vul aan</b>	20 h/u	<b>Machine oil, Universal</b> Masjienolie, Algemeen

Bale Fork / Long Beam / Bale Fork + Long Beam 2.7m  
A7101 / A7105 / A7111

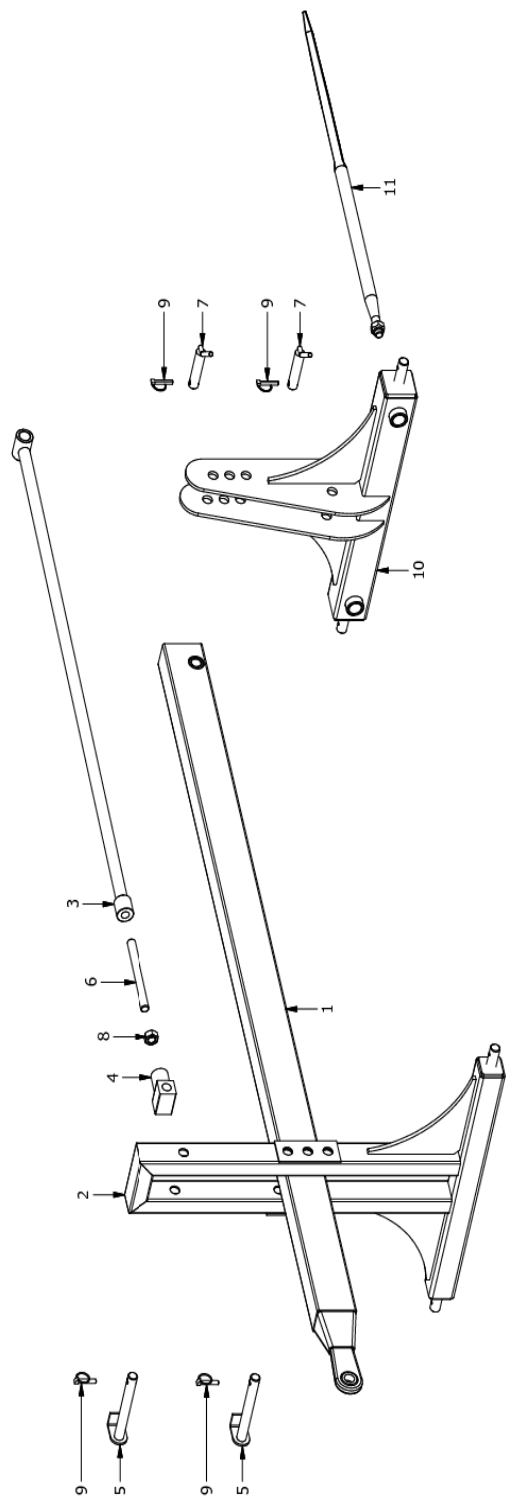
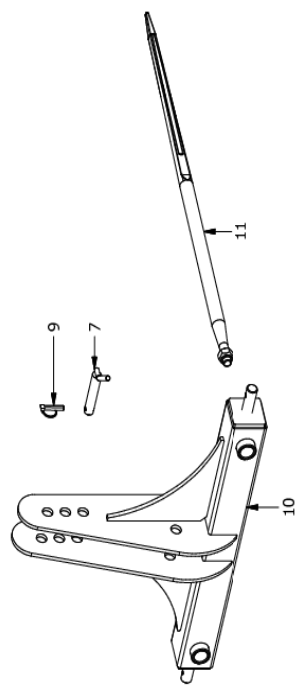
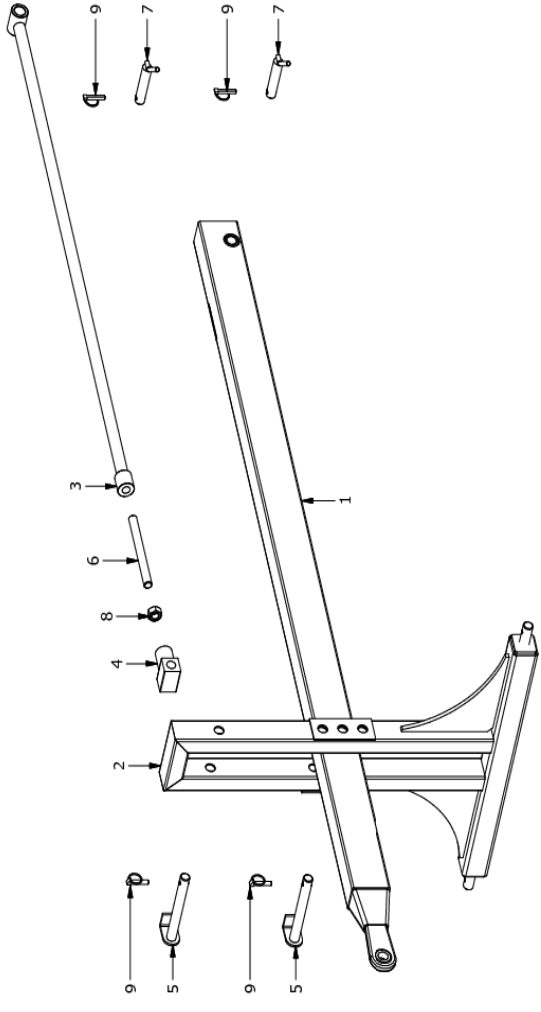

**Bale Fork  
A7111**

**Long Beam  
A7105**

Item	Part No.	Description	Qty	Item	Part No.	Description	Qty
7	H0634	Pin Top link Cat 2-125mm	1	1	H7126	Beam	1
9	FLP11	Lynchpin 11mm	1	2	H7130	Carrier mast	1
10	H7110	Bale fork	1	3	H7121	Adjust arm	1
11	M7137	Bale spike + Nut M22	2	4	H7127	Adjust block M24	1
14	M3175	Decal PROUD TO BE SOUTH AFRICAN	1	5	H7135	Pin Pivot Cat 2-235mm	2
15	M3086	Decal Falcon Logo 65x110	2	6	M7136	Thread bar M24x250	1
16	M3182	Decal Check fitting position	1	7	H7115	Pin Btm link Cat2 125mm	2
20	M8403	Operators manual Material Handling	1	8	M32418	Nut M24	1
				9	FLP11	Lynchpin 11mm	4
				12	M3169	Decal Bird FALCON Small	1
				13	M3075	Decal Warning (Bale Loader)	1
				14	M3175	Decal PROUD TO BE SOUTH AFRICAN	1
				20	M8403	Operators manual Material Handling	1

**Bale Fork and Long Beam  
A7101**

Item	Part No.	Description	Qty	Item	Part No.	Description	Qty
1	H7126	Beam	1	1	H7126	Beam	1
2	H7130	Carrier mast	1	2	H7130	Carrier mast	1
3	H7121	Adjust arm	1	3	H7121	Adjust arm	1
4	H7127	Adjust block M24	1	4	H7127	Adjust block M24	1
5	H7135	Pin Pivot Cat 2-235mm	2	5	H7135	Pin Pivot Cat 2-235mm	2
6	M7136	Thread bar M24x250	1	6	M7136	Thread bar M24x250	1
7	H7115	Pin Btm link Cat2 125mm	2	7	H7115	Pin Btm link Cat2 125mm	2
8	M32418	Nut M24	1	8	M32418	Nut M24	1
9	FLP11	Lynchpin 11mm	4	9	FLP11	Lynchpin 11mm	4
10	H7110	Bale fork	1	10	H7110	Bale fork	1
11	M7137	Bale spike + Nut M22	2	11	M7137	Bale spike + Nut M22	2
12	M3169	Decal Bird FALCON Small	1	12	M3169	Decal Bird FALCON Small	1
13	M3075	Decal Warning (Bale Loader)	1	13	M3075	Decal Warning (Bale Loader)	1
14	M3175	Decal PROUD TO BE SOUTH AFRICAN	1	14	M3175	Decal PROUD TO BE SOUTH AFRICAN	1
15	M3086	Decal Falcon Logo 65x110	2	15	M3086	Decal Falcon Logo 65x110	2
16	M3182	Decal Check fitting position	1	16	M3182	Decal Check fitting position	1
20	M8403	Operators manual Material Handling	1	20	M8403	Operators manual Material Handling	1

F750 Uniloader® with spike attachment, swivel hook and control valve  
A7500 / A7501

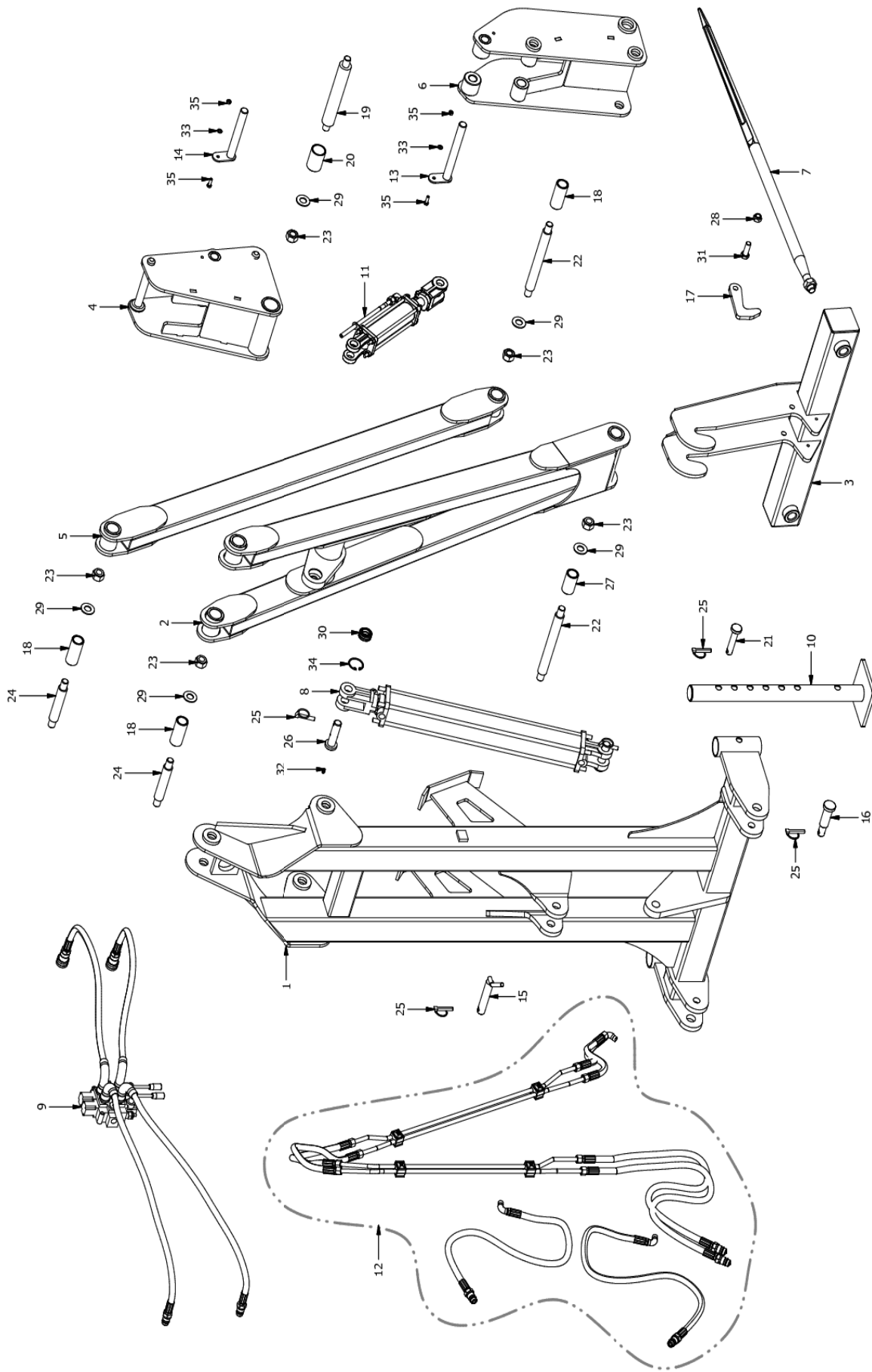

**F750 Uniloader® with spike attachment, swivel hook and control valve  
A7500 / A7501**

Item	Part No.	Description	Qty	Item	Part No.	Description	Qty
1	H9000	Mast	1	41	M3239	Decal RETURN TO REST POSITION	2
2	H9001	Boom Lower	1	42	M3003	Serial plate Metal FALCON	1
3	H9005	Bale fork	1				
4	H9004A	Head Inner	1				
5	H9002	Boom Upper	1				
6	H9003A	Head Outer	1				
7	M7137	Bale spike + Nut M22	2				
8	M7415	Cylinder Hydraulic DB30024-150	1				
9	H9049	Kit Hydraulic Remote	1				
10	H9027	Parking stand Adjustable	2				
11	M7416B	Cylinder Hydraulic DB20006-106	1				
12	M9191	Kit Hydraulic	1				
13	H9064	Pin D25x235 + Tab washer	1				
14	H9063	Pin D25x202 + Tab washer	1				
15	H0634	Pin Top link Cat 2-125mm	1				
16	H0645	Pin Bottom Link Cat2	2				
17	M3722	Safety latch Bale fork	2				
18	H9009	Bush 30x40x90 Supamide	4				
19	H9006	Pin D40x300-M22	1				
20	H9023	Bush D40x48x70 Supamide	2				
21	H0631	Pin Top link Cat1	2				
22	H9007	Pin D30x300-M22	2				
23	M62222	Nut Nyloc M22	12				
24	H9008	Pin D30x190-M22	3				
25	FLP11	Lynchpin 11mm	7				
26	H9019	Pin D25 special	2				
27	H9011	Bush 30x40x70 Supamide	2				
28	M61616	Nut Nyloc M16	2				
29	M3721	Washer 23x45x3	12				
30	M7419	Bearing GE25ES	1				
31	M41645	Bolt M16x45 HT	2				
32	M10039	Grease nipple 1/8inch	1				
33	M80803	Washer Flat M8	2				
34	M7420	Circlip Int 42.0	1				
35	M10825	Bolt+nut M8x25	4				
36	M3182	Decal Check fitting position	1				
37	M3198	Decal F750 Uniloader	2				
38	M3086	Decal Falcon Logo 65x110	2				
39	M3181	Decal Max. Load 750Kg	1				
40	M3175	Decal PROUD TO BE SOUTH AFRICAN	1				

F1000 Uniloader® with spike attachment, swivel hook, cruciform and control valve  
A7502 / A7503/ A7504 / A7505 / A7506

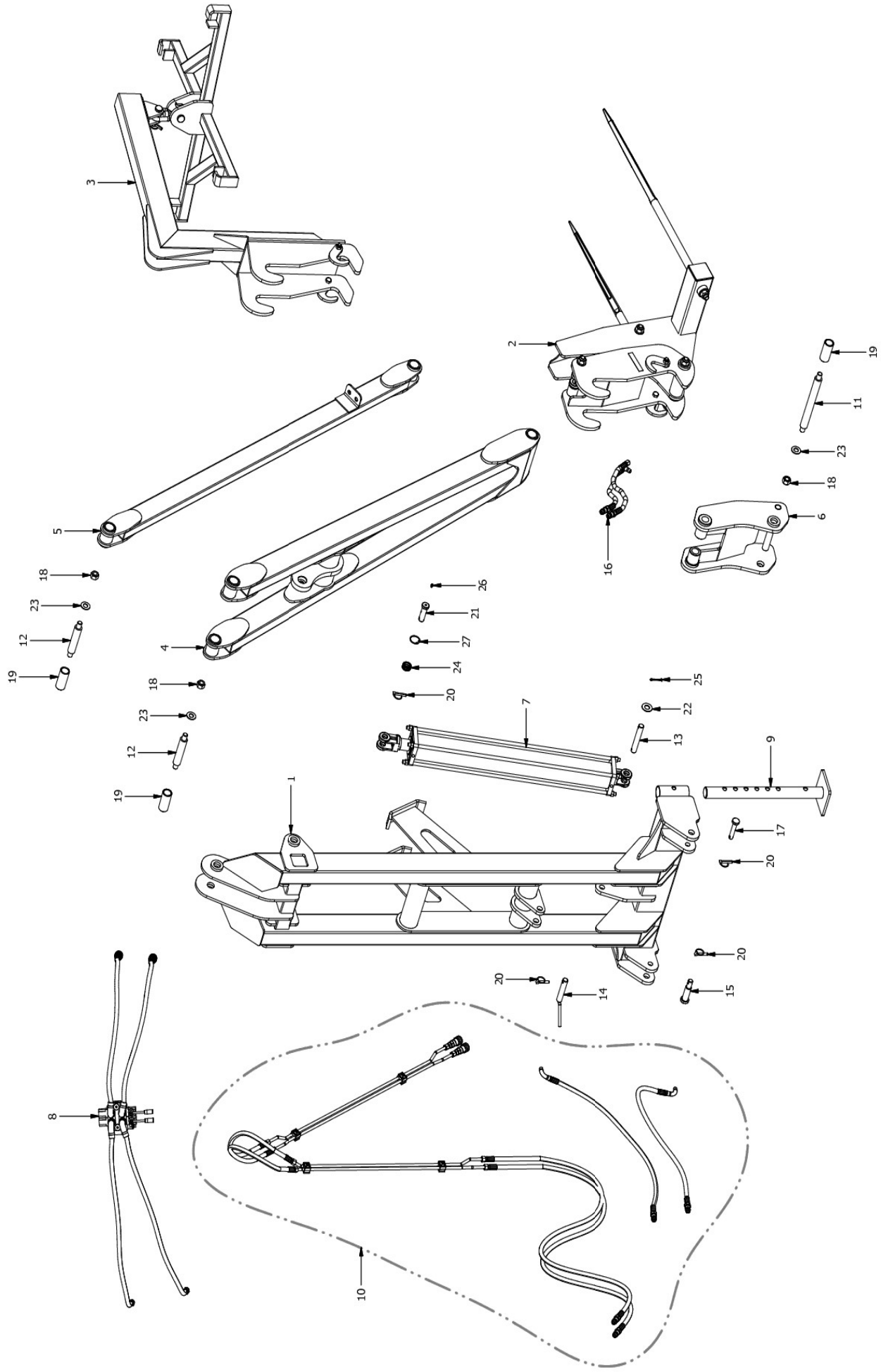

**F1000 Uniloader® with spike attachment, swivel hook, cruciform and control valve**  
**A7502 / A7503/ A7504 / A7505 / A7506**

Item	Part No.	Description	Qty	Item	Part No.	Description	Qty
1	H9100	Mast	1				
2	A7512	Bale fork Assembly	1				
3	A7513	Hook + Cruciform	1				
4	H9101	Boom	1				
5	H9102	Top Link	1				
6	H9103	Head mount	1				
7	M9150	Cylinder Hyd DB40036-200	1				
8	H9049	Kit Hydraulic Remote	1				
9	H9027	Parking stand Adjustable	2				
10	M9192	Kit Hydraulic	1				
11	M9146	Pin D35x356 M22	2				
12	M9147	Pin D35x207 M22	3				
13	M9151	Pin D25x158-136	1				
14	H0634	Pin Top link Cat2-125	1				
15	H0645	Pin Btm link Cat2/1	2				
16	M9193	Kit Hydraulic	1				
17	H0631	Pin Top link Cat1	2				
18	M62222	Nut Nyloc M22	10				
19	M9126	Bush 35.3x45x100 Supamide	6				
20	FLP11	Lynchpin 11mm	6				
21	H9019	Pin D25 special	1				
22	M9165	Washer 25x50x3	2				
23	M3721	Washer 23x45x3	10				
24	M7419	Bearing GE25ES	1				
25	M1416	Split pin B5x60	2				
26	M10039	Grease nipple 1/8inch	1				
27	M7420	Circlip Int 42.0	1				
28	M3003	Serial plate Metal FALCON	1				
29	M3169	Decal Bird FALCON Small	2				
30	M3199	Decal F1000 Uniloader	2				
31	M3239	Decal RETURN TO REST POSITION	2				



F2250 Bale Grab  
A7525

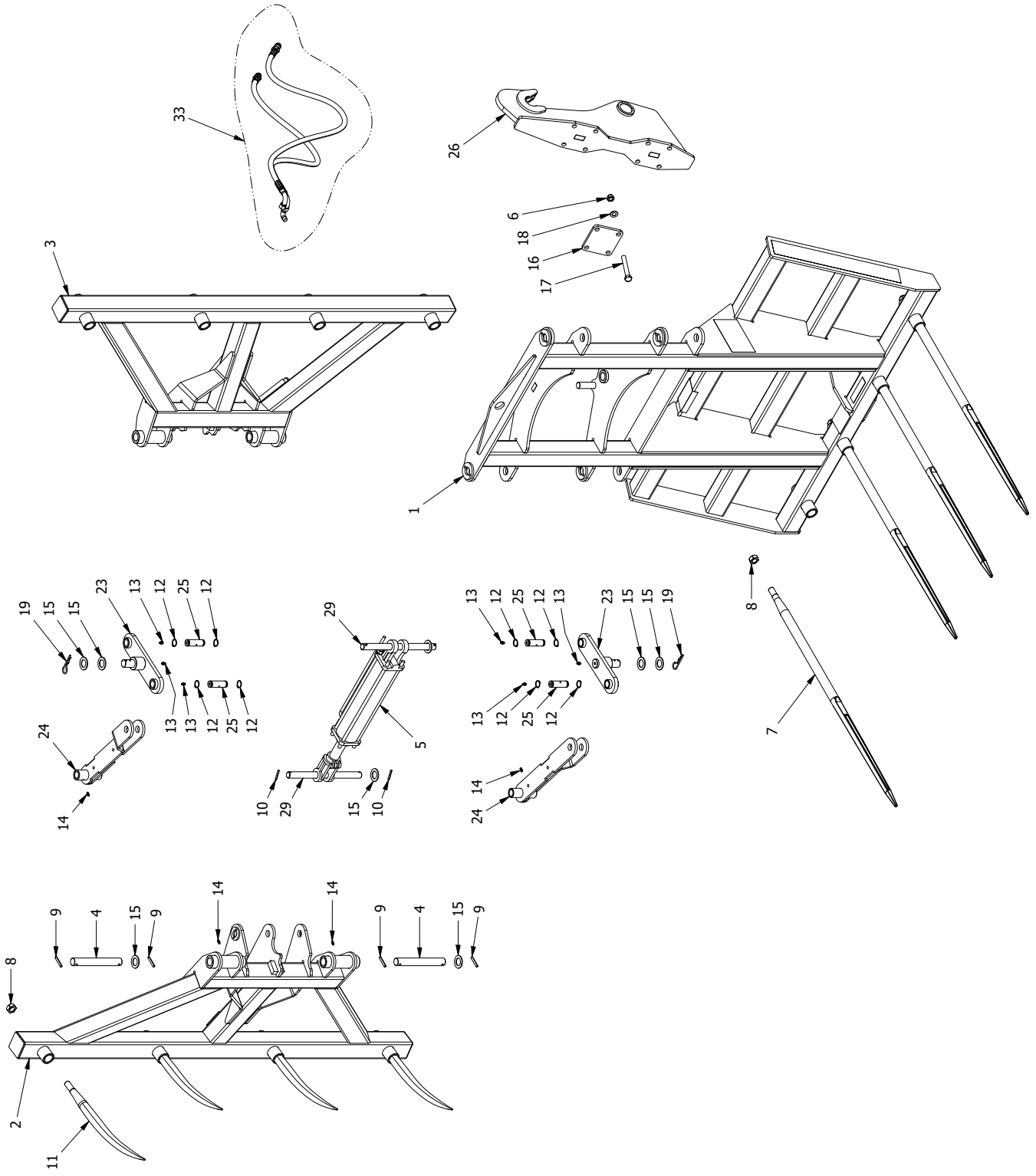

F2250 Bale Grab  
A7525

Item	Part No.	Description	Qty	Item	Part No.	Description	Qty
1	H7850	Frame Center Bale Grab	1				
2	H7870	Wing Right	1				
3	H7860	Wing Left	1				
4	H7885	Pin D30x227-203 Galv	4				
5	M7874	Cylinder Hydraulic TK30014-150	1				
6	M61616	Nut Nyloc M16 Galv	16				
7	M7137	Bale spike + Nut M22	4				
8	M7137-Nut	Nut M22x1.5	12				
9	M5594	Roll pin M8x50	8				
10	M5593	Roll pin M6x40	4				
11	M7875	Loader tine Curved 680	8				
12	M5242	Circlip External EXT0250	8				
13	M10039	Grease nipple 1/8inch	6				
14	M10070	Grease Nipple 9mm	8				
15	M7774	Washer 30.5x50x3 Galv	10				
16	M7878	Attachment plate Galv	4				
17	M416130	Bolt M16x130 HT Galv	16				
18	M81602	Washer Flat M16x40x2	16				
19	M5235	R-clip 4mm	2				
20	M3003	Serial plate Metal FALCON	1				
21	M3169	Decal Bird FALCON Small	2				
22	M3175	Decal PROUD TO BE SOUTH AFRICAN	1				
23	H7880	Toggle link Balance assy	2				
24	H7890	Linkage Balance	4				
25	H7891	Pin Link retaining	4				
26	H7895	Adapter Wacker Neuson	2				
27	M3182	Decal Check fitting position	3				
28	M3195	Decal Grease Point	5				
29	H7886	Pin D25x186-168 Galv	2				
30	M3189	Decal Max. Load 2200kg	1				
31	M3191	Decal F2250 Bale Grab	2				
32	M3173	Decal Lifting hook	1				
33	M7876	Kit Hydraulic A7525	1				

**FALCON AGRICULTURAL EQUIPMENT (EDMS) BPK**

Reg Nr. 2006/012163/07  
15 Mopanestraat, Merrivale, 3291, KwaZulu-Natal, Suid Afrika  
Posbus 170, Howick, 3290, KwaZulu-Natal, Suid Afrika  
Tel: +27 (0) 33 330 4764  
Verkope: +27 (0) 33 330 5787  
info@falconequipment.co.za  
www.falconequipment.co.za



**FALCON AGRICULTURAL EQUIPMENT (PTY) LTD**

Reg No. 2006/012163/07  
15 Mopane Road, Merrivale, 3291, KwaZulu-Natal, South Africa  
P.O. Box 170, Howick, 3290, KwaZulu-Natal, South Africa  
Tel: +27 (0) 33 330 4764  
Sales: +27 (0) 33 330 5787  
info@falconequipment.co.za  
www.falconequipment.co.za

